

ASSEMBLY INSTRUCTIONS

MODEL : HD101A / HD102A
QUEEN / FULL (4+4)

(Box 1)

BOX OF HEADBOARD & FOOTBOARD

No	ITEM	Qty
A	Headboard	1 pc
B	Footboard	1 pc
C	Headboard Leg (L)	1 pc
D	Headboard Leg (R)	1 pc
E	Footboard Leg (L)	1 pc
F	Footboard Leg (R)	1 pc
G	Bed Slats	4 pcs
H	Bed Slats Support	4 pcs

(Box 2)

BOX OF SIDE RAIL

No	ITEM	Qty
I	Side Rail	2 pcs

(Box 1)

HARDWARE LIST

No	ITEM	Qty
1	Csk M4 x 32mm	8 pcs
2	JCBC M6 x 35mm	12 pcs
3	JCBC M6 x 50mm	2 pcs
4	SpringWasher 1/4" Blk	14 pcs
5	Flat Washer 1/4"ID x 13mmOD Blk	12 pcs
6	Band Washer 15mm x 25mm Rbw	2 pc
7	Wood Dowel 8mm x 30mm	4 pcs
8	Allen Key m4 x 65mm Blk	1 pc
9	Allen Key m5 x 65mm Blk	1 pc
10	Unitar Screw m7 x 60mm	2 pcs

STEP 1.1 : Attach Head Board Leg (C) & (D) to Head Board (A) . using JCBC BOLT (2)with Spring Washer (4), Flat washer (5) and securing with ALLEN KEY (8) .

STEP 1.2 : Using Unitar Screw (10)and securing with ALLEN KEY (8) as shown.

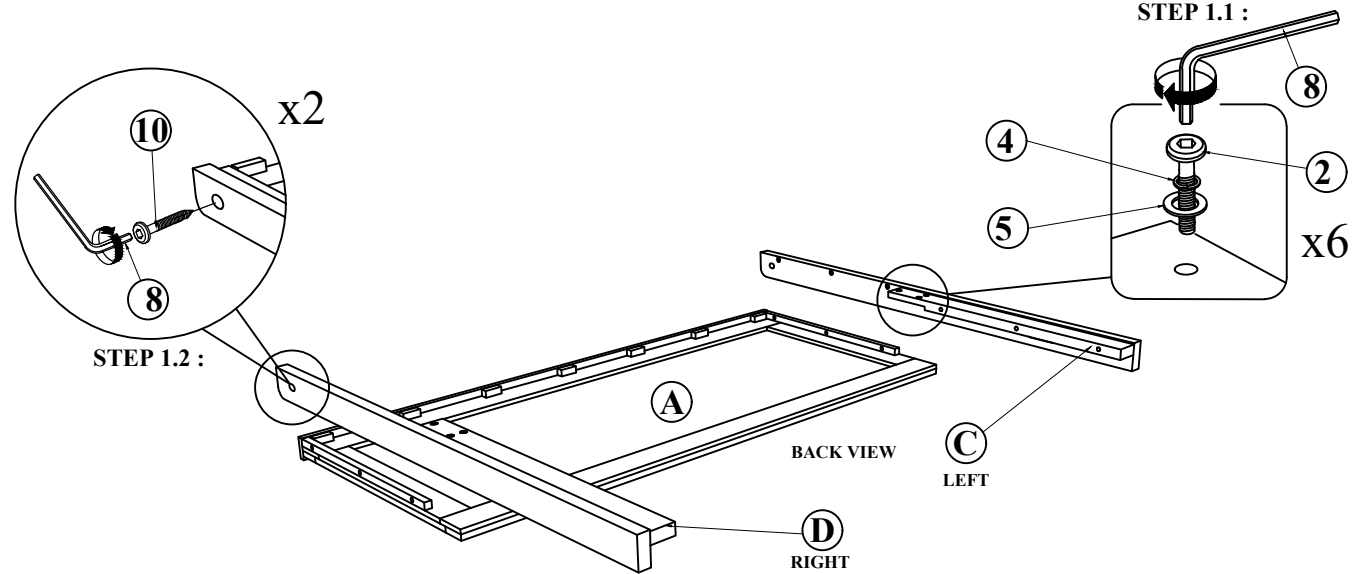

STEP 2 : Using JCBC BOLT (2)with Spring Washer (4), Flat washer (5) and securing with ALLEN KEY (8) as shown .

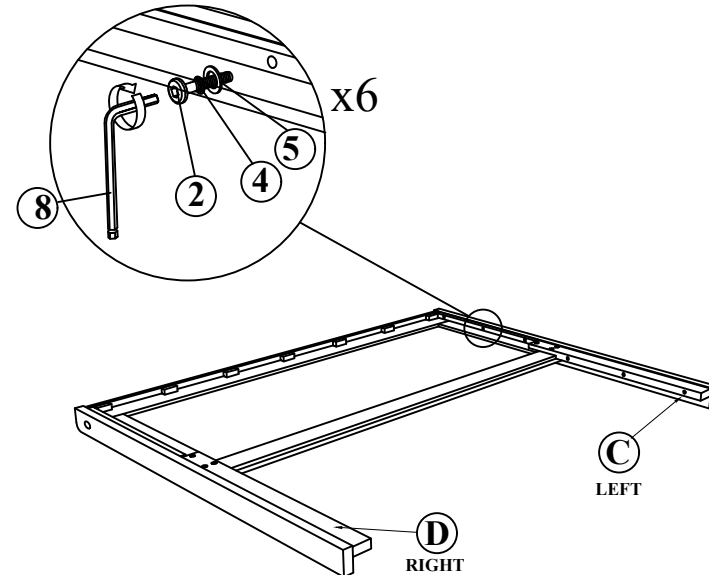

NOTE : MUST TIGHTEN SCREWS PERIODCALLY WITH USE SCREW WILL BECOME LOOSE CHECK TIGHTNESS OF ALL SCREW EVERY 6-8 WEEKS.

1 OF 2

ASSEMBLY INSTRUCTIONS

STEP 3 : Attach Footboard Leg (E) & (F) to Footboard (B) as shown using Wood Dowel (7) and fix it as shown.

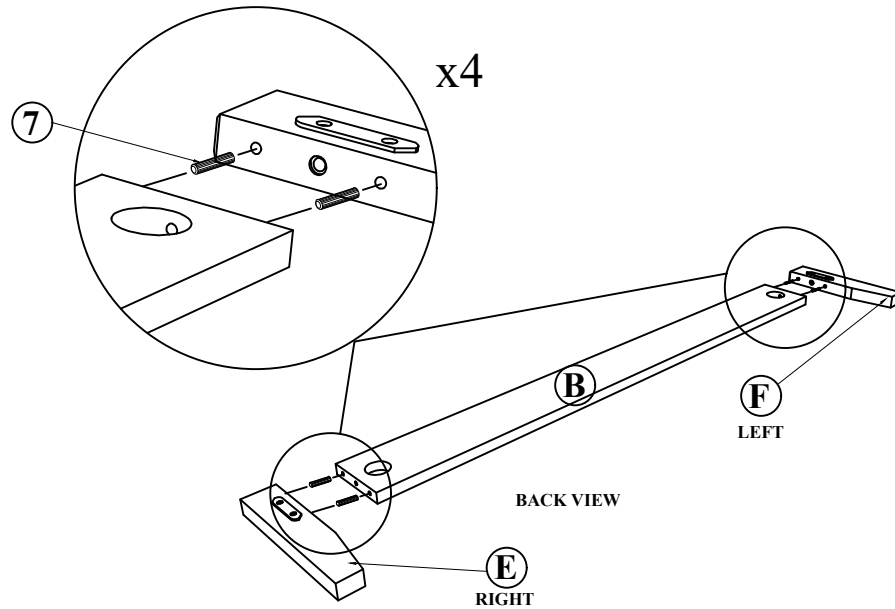

STEP 4 : Using JCBC BOLT(3) with Spring Washer (4), Band washer (6) and securing with ALLEN KEY (8) as shown .

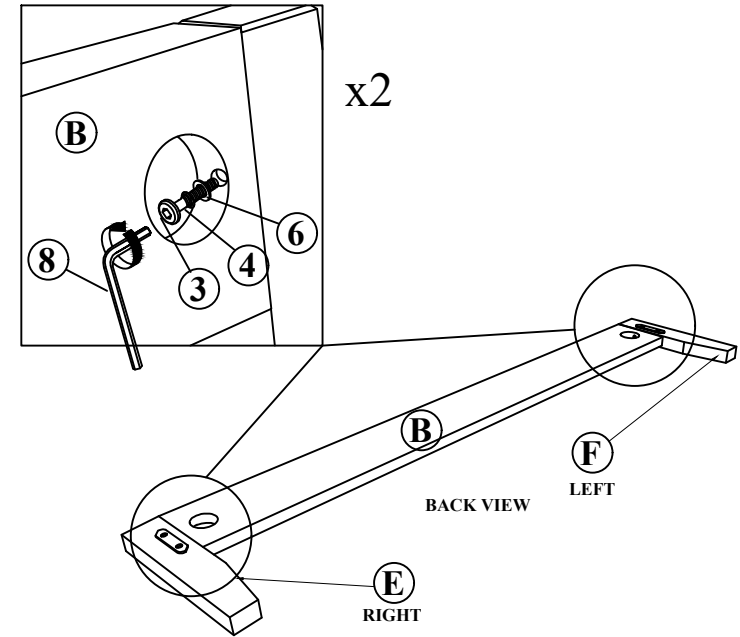

STEP 5 : Hook SIDE RAIL (I) TO HEAD BOARD (A) closely and push down to fit. repeat step 2 with other end of rail to hook onto FOOTBOARD (B).

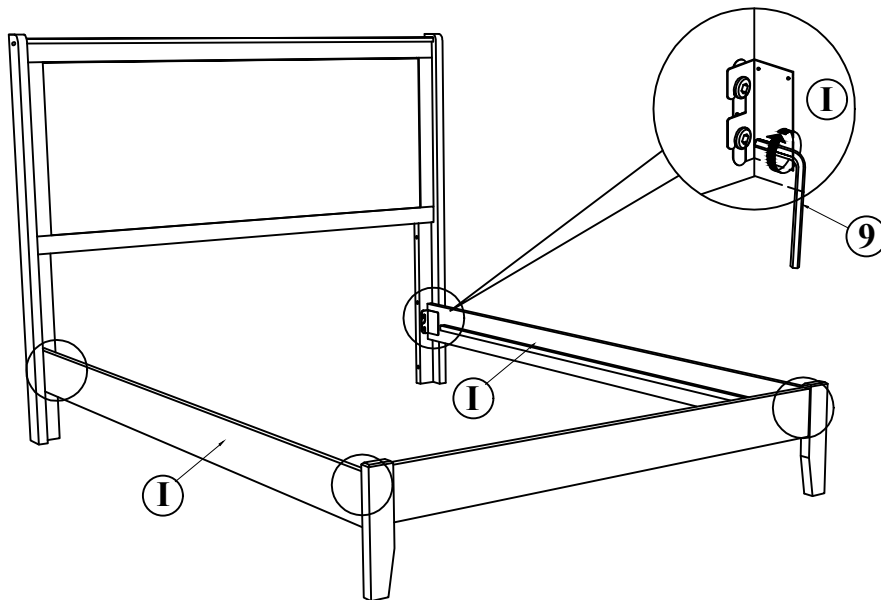

STEP 6 : Tighten the 4 Corner with Allen Key (9). Fix the Bed Slat Support Leg (H), to Bed Slat (G) as shown . Install the bed slat (G) to side rail (I) and tighten with Csk Screw (1) as per diagram shown. (NOTE: THE SETUP MUST DONE AT THE DECIDED LOCATION FOR THE BED TO OBTAIN PERFECT STABILITY)

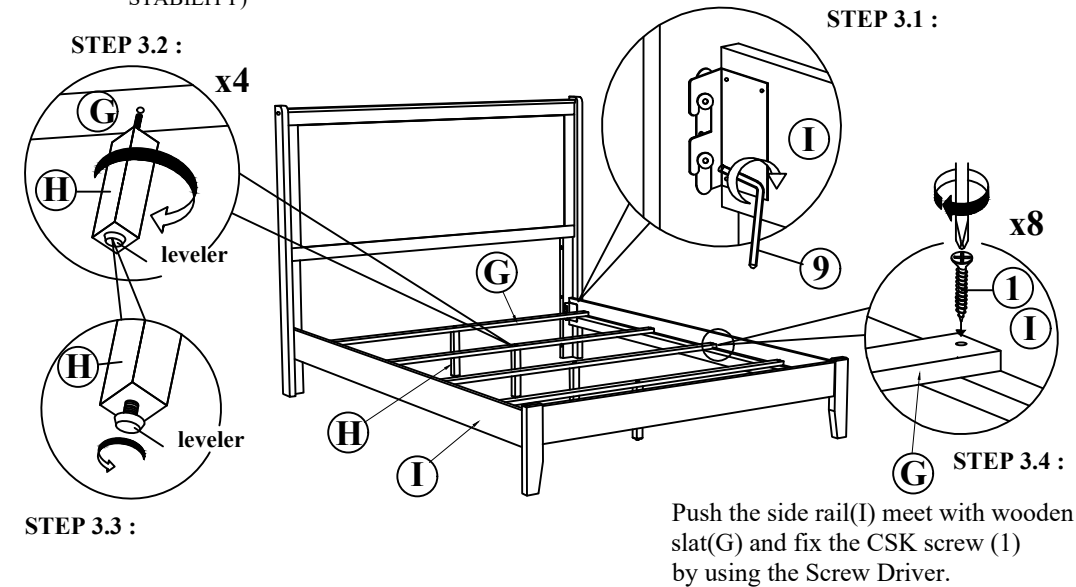

NOTE : MUST TIGHTEN SCREWS PERIODCALLY WITH USE SCREW WILL BECOME LOOSE CHECK TIGHTNESS OF ALL SCREW EVERY 6-8 WEEKS.

ASSEMBLY INSTRUCTIONS

MODEL : HD101A / HD102A
TWIN (4+0)

(Box 1)

BOX OF HEADBOARD & FOOTBOARD

No	ITEM	Qty
A	Headboard	1 pc
B	Footboard	1 pc
C	Headboard Leg (L)	1 pc
D	Headboard Leg (R)	1 pc
E	Footboard Leg (L)	1 pc
F	Footboard Leg (R)	1 pc
G	Bed Slats	4 pcs

(Box 2)

BOX OF SIDE RAIL

No	ITEM	Qty
H	Side Rail	2 pcs

(Box 1)

HARDWARE LIST

No	ITEM	Qty
1	Csk M4 x 32mm	8 pcs
2	JCBC M6 x 35mm	12 pcs
3	JCBC M6 x 50mm	2 pcs
4	SPRING WASHER 1/4" Rbw	14 pcs
5	Flat Washer 1/4"ID x 13mmOD Blk	12 pcs
6	Band Washer m4x65mm Blk	2 pc
7	Wood Dowel	4 pcs
8	ALLEN KEY m4x65mm Blk	1 pc
9	ALLEN KEY m5x65mm Blk	1 pc
10	UNITAR SCREW m7 x 60mm	2 pcs

STEP 1.1 : Attach Head Board Leg (C) & (D) to Head Board (A) . using JCBC BOLT(2)with Spring Washer (4), Flat washer (5) and securing with ALLEN KEY (8).

STEP 1.2 : Using Unitar Screw (10)and securing with ALLEN KEY (8).

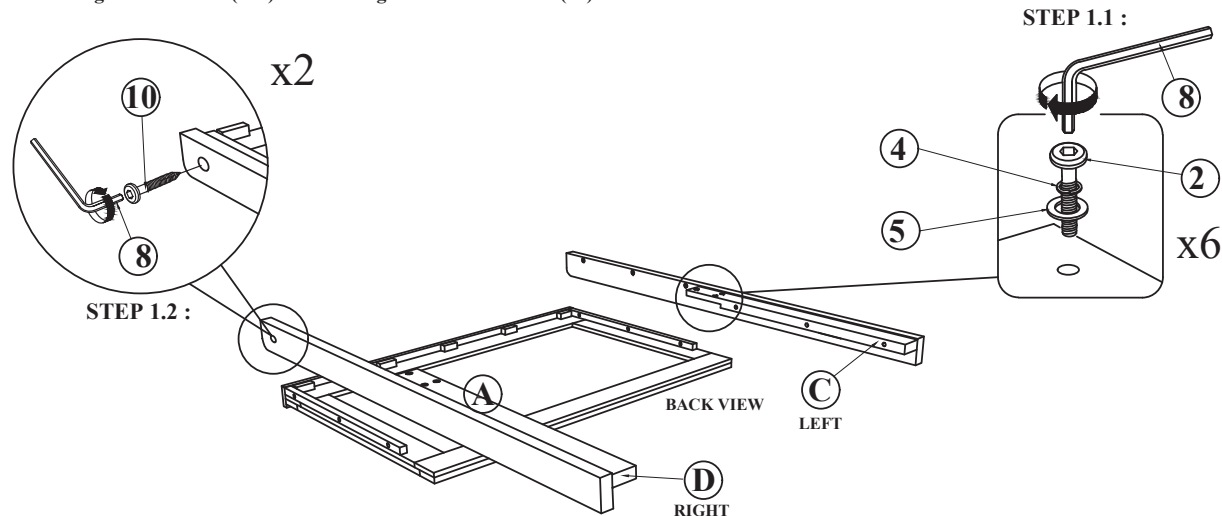

STEP 2 : Using JCBC BOLT(2)with Spring Washer (4), Flat washer (5) and securing with ALLEN KEY (8) as shown .

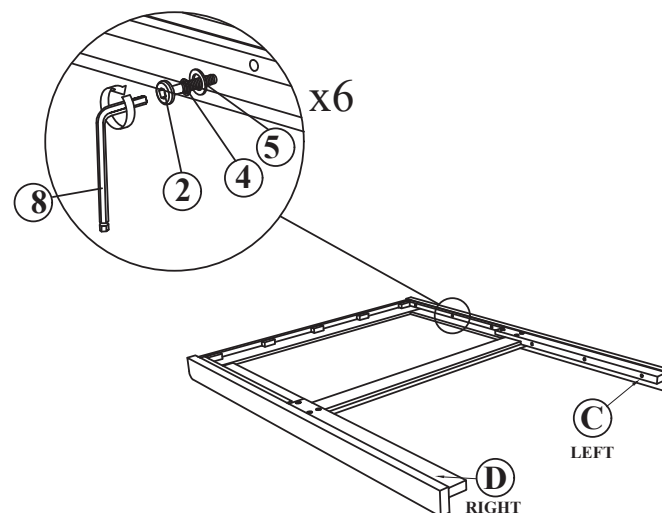

NOTE : MUST TIGHTEN SCREWS PERIODCALLY WITH USE SCREW WILL BECOME LOOSE CHECK TIGHTNESS OF ALL SCREW EVERY 6-8 WEEKS.

1 OF 2

ASSEMBLY INSTRUCTIONS

STEP 3 : Attach Footboard Leg (E) & (F) to Footboard (B) as shown using Wood Dowel (7) and fix it as shown.

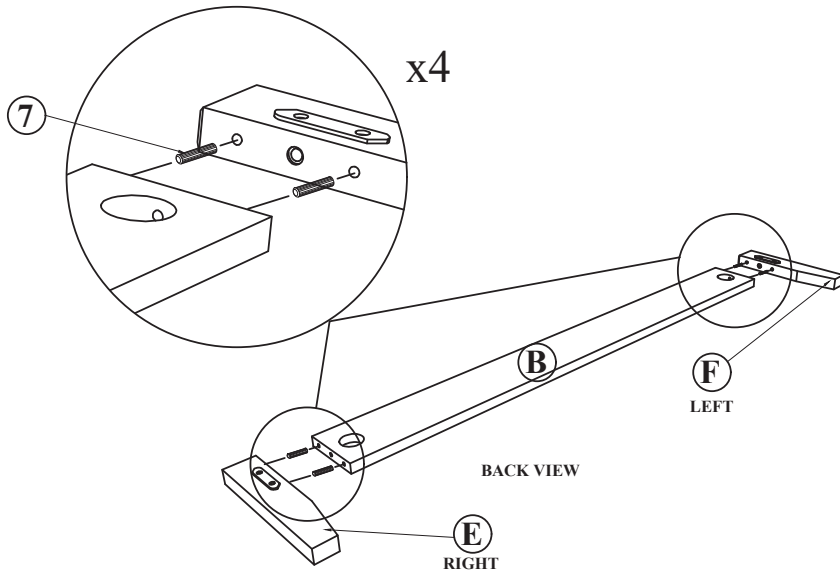

STEP 4 : Using JCBC BOLT(3) with Spring Washer (4), Band washer (6) and securing with ALLEN KEY (8) as shown .

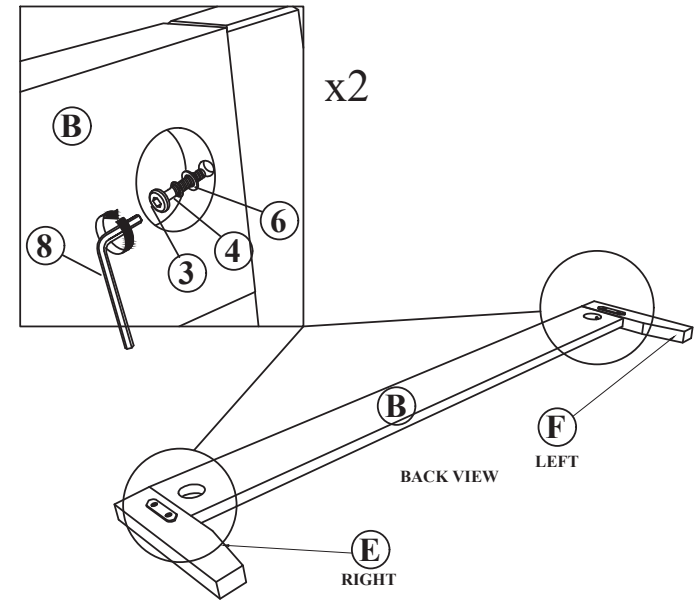

STEP 5 : Hook SIDE RAIL (H) TO HEAD BOARD (A) closely and push down to fit. repeat step 2 with other end of rail to hook onto FOOTBOARD (B).

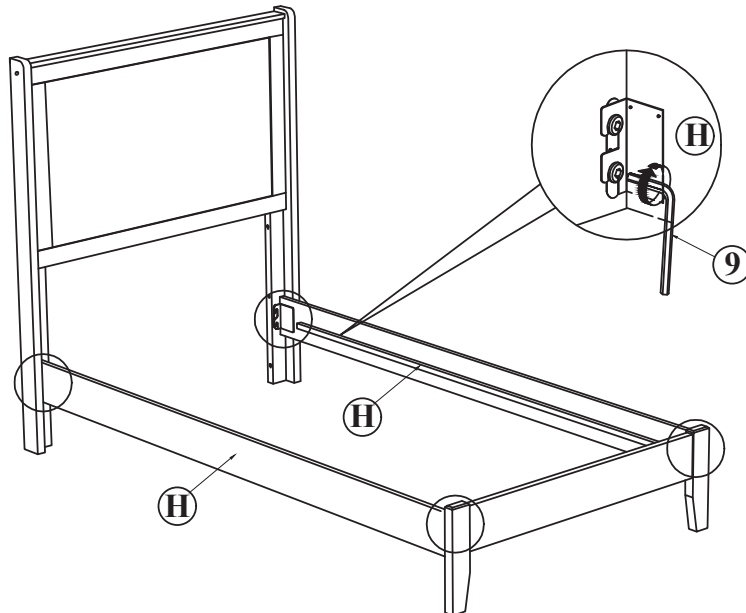

STEP 6 : Tighten the 4 Corner with Allen Key (9). Install the bed slat (G) to side rail (H) and tighten with Csk Screw (1) as per diagram shown. (NOTE: THE SETUP MUST DONE AT THE DECIDED LOCATION FOR THE BED TO OBTAIN PERFECT STABILITY)

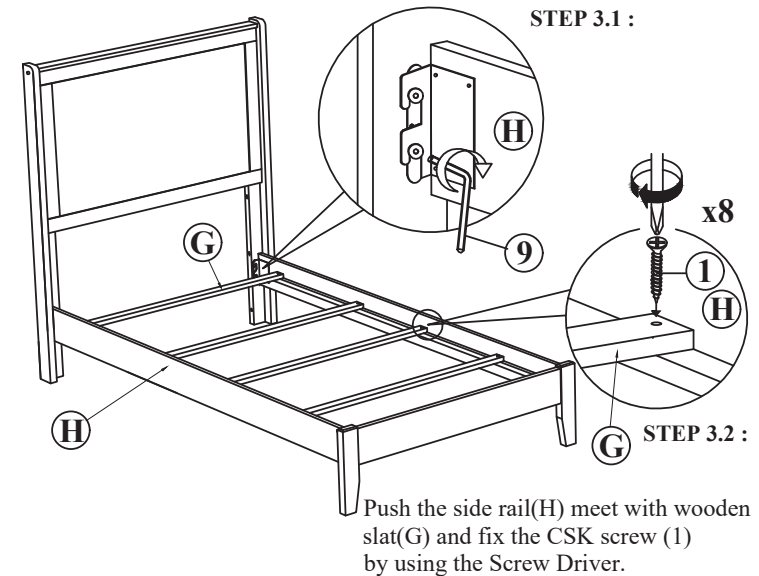

Push the side rail(H) meet with wooden slat(G) and fix the CSK screw (1) by using the Screw Driver.

NOTE : MUST TIGHTEN SCREWS PERIODCALLY WITH USE SCREW WILL BECOME LOOSE CHECK TIGHTNESS OF ALL SCREW EVERY 6-8 WEEKS.

2 OF 2

ASSEMBLY INSTRUCTION

FOR HD101A / HD102A - NIGHTSTAND ,CHEST & DRESSER

STEP 1

Pull the drawer and take out the Leg carton (A).

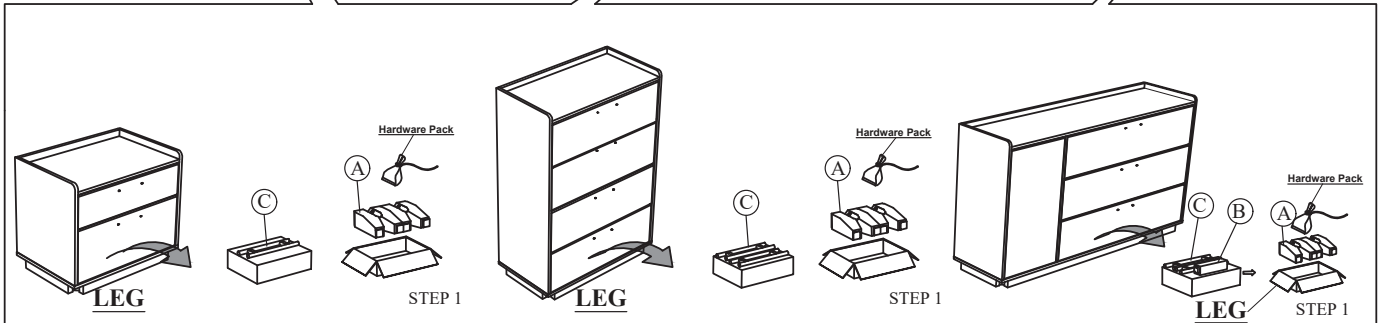
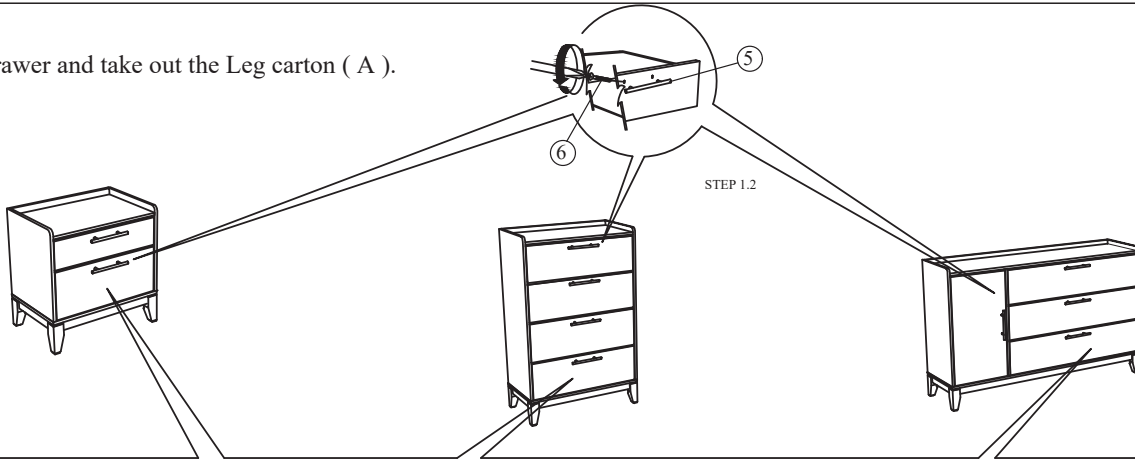

STEP 3

Assemble the Bun Foot (A) as shown.

Night Stand

No	Hardware List	Qty
5	HANDLE	2 pcs
6	Truss Head Machine Screw m4 x 20mm	4 pcs

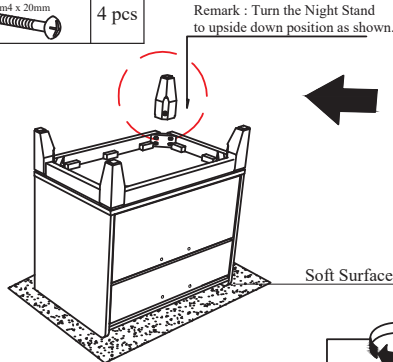

Chest

Remark : Turn the Chest to upside down position as shown.

No	Hardware List	Qty
5	HANDLE	4 pcs
6	Truss Head Machine Screw m4 x 20mm	8 pcs

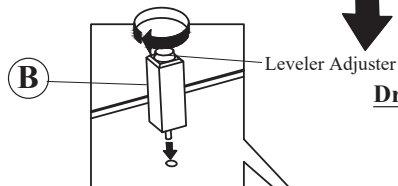
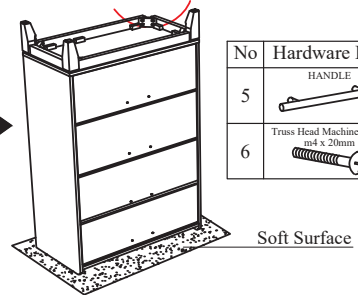

Dresser

Remark : Turn the Dresser to upside down position as shown.

No	Hardware List	Qty
5	HANDLE	4 pcs
6	Truss Head Machine Screw m4 x 20mm	8 pcs

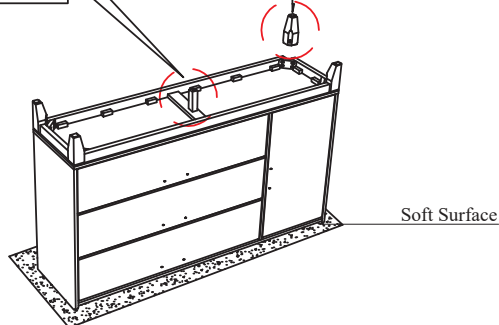

No	Part List	Qty
A	LEG	4 pcs
B	BOTTOM CENTER LEG (30 x 30 x 120MM)	1 pc

No	Hardware List	Qty
1	JCBC Bolt m6x50mm Blk	4 pcs
2	Spring Washer 1/4" Rbw	4 pcs
3	Flat Washer 1/4"Dx13mmOD Blk	4 pcs
4	Allen Key m4x65mm With Ball Blk	1 pc

NOTE : MUST TIGHTEN SCREWS PERIODCALLY WITH USE SCREW WILL BECOME LOOSE CHECK TIGHTNESS OF ALL SCREW EVERY 6-8 WEEKS.

ASSEMBLY INSTRUCTION

**MODEL : HD101A / HD102A
DRESSER & MIRROR**

(Box 1)

BOX OF MIRROR

NO	ITEM	Qty
A	MIRROR	1 PC

(Box. 2)

BOX OF DRESSER

NO	ITEM	Qty
B	DRESSER	1 PC

NO	ITEM	Qty
C	MIRROR SUPPORT RAIL	2 PCS

(Box. 1)

HARDWARE LIST

NO	ITEM	Qty
1	Csk M4 x 32mm	10 PCS

STEP 1 : Cut the rope and rotate the Back Mirror Support (C) upward before tightening the screw.

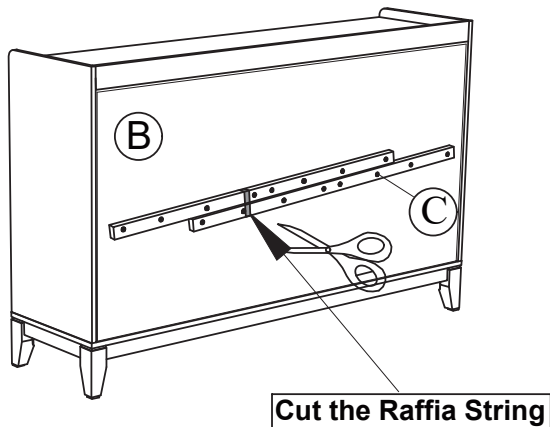

STEP 2 : Turn the Mirror Support Rail (C) upward at the back of Dresser (B), then tighten with CSK Screw (1).

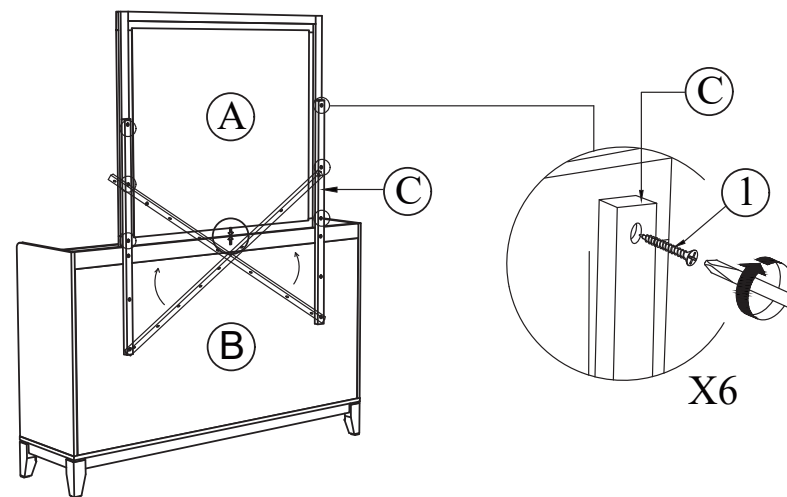

STEP 3 :
Place the mirror (A) on top of the dresser (B) as shown.
Tighten with CSK screw (1).

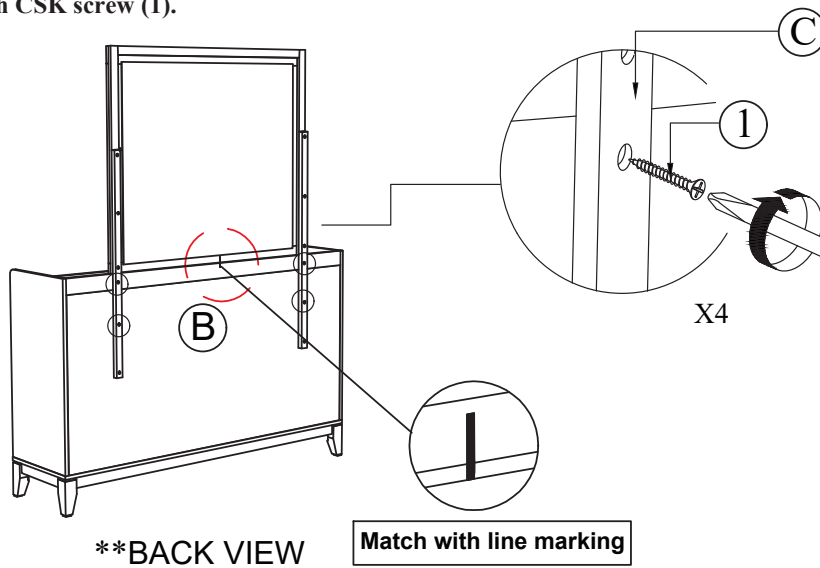

NOTE : MUST TIGHTEN SCREWS PERIODCALLY WITH USE SCREW WILL BECOME LOOSE CHECK TIGHTNESS OF ALL SCREW EVERY 6-8 WEEKS.